

Items in red for left hand model (321)

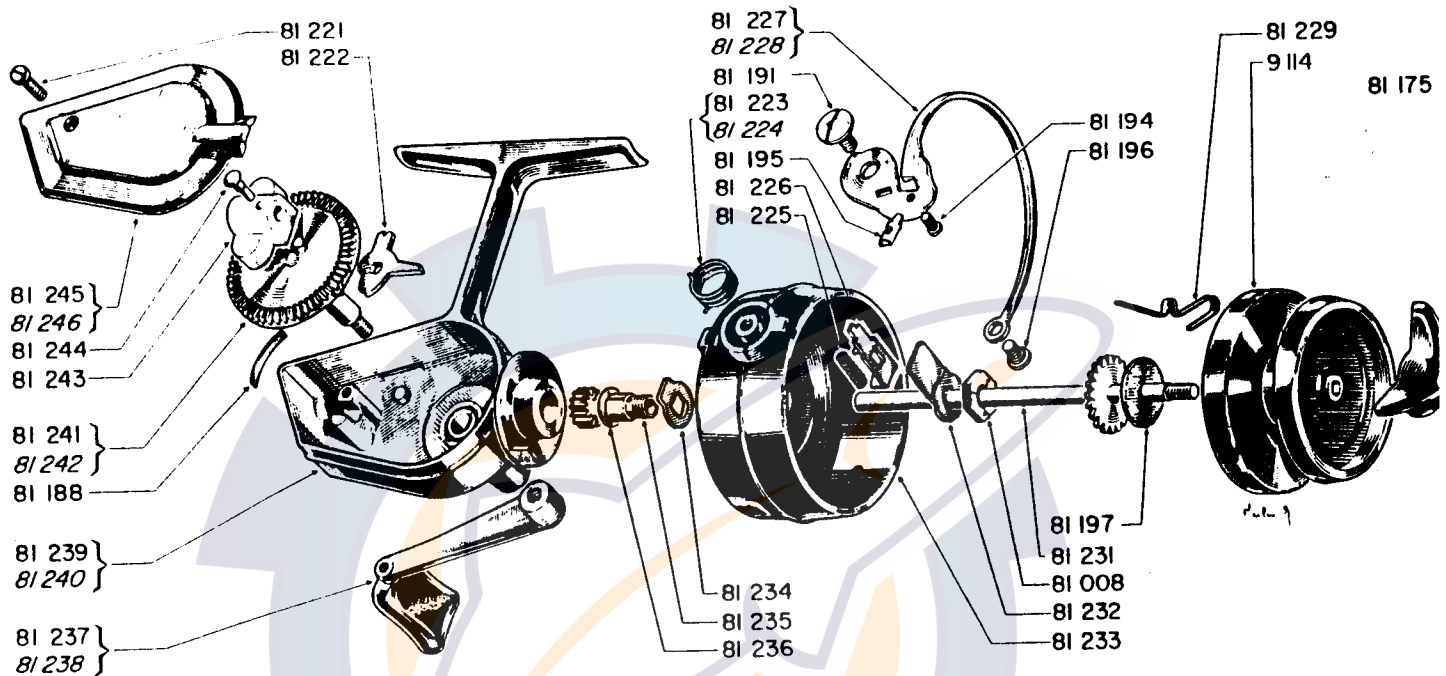

Prices subject to change without notice

Please specify both the reel model and part numbers when ordering.

No.	Part Name	Price	No.	Part Name	Price	No.	Part Name	Price
9114 (36)	Spool Standard	1.25	81224 (23L)	Bail Spring (321)	.15	81237 (16)	Handle (320)	1.25
81008 (14)	Hex Nut	.10	81225 (24)	Bail Trip Spring	.10	81238 (16L)	Handle (321)	1.25
81175 (8)	Drag Adjusting Knob	.15	81226 (21)	Bail Trip	.20	81239 (4)	Housing (320)	2.75
81188 (22)	Anti Reverse Lever Spring	.10	81227 (20)	Bail (320)	1.75	81240 (4L)	Housing (321)	2.75
81191 (32)	Bail Screw No. 1	.15	81228 (20L)	Bail (321)	1.75	81241 (10)	Drive Gear (320)	1.00
81194 (31)	Line Guide Screw	.10	81230 (12)	Click Spring	.25	81242 (10L)	Drive Gear (321)	1.00
81195 (7)	Line Guide	.40	81231 (1)	Axle	.50	81243 (9)	Oscillation Slide	.10
81196 (33)	Bail Screw No. 2	.15	81232 (18)	Bail Trip Plate	.10	81244 (2)	Oscillation Slide Lock	.10
81197 (27)	Drag Washer	.10	81233 (29)	Rotating Head	1.30	81245 (11)	Side Plate (320)	.30
81221 (30)	Side Plate Screw	.10	81234 (3)	Keyed Washer	.10	81246 (11L)	Side Plate (321)	.30
81222 (15)	Anti Reverse Lever	.15	81235 (17)	Pinion Gear	.65			
81223 (23)	Bail Spring (320)	.15	81236 (26)	Thrust Washer	.10			

PARTS AND SERVICE AVAILABLE AT THE FOLLOWING REGIONAL FACTORY REPAIR DEPOTS:

**FACTORY SERVICE
RODS, REELS AND PARTS**

**THE GARCIA SERVICE DEPARTMENT
329 ALFRED AVENUE
TEANECK, NEW JERSEY 07666**

**THE CONOLON CORPORATION
1111 EAST McFADDEN STREET
SANTA ANA, CALIFORNIA 92705**

**SILICOTE SALES DIVISION
520 WEST 14th AVENUE
OSHKOSH, WISCONSIN 54902**

**J. K. CLARK COMPANY
ACO SPORTSMEN SERVICE
13501 VAN DYKE
DETROIT, MICHIGAN 48234**

REEL SERVICE AND PARTS

**NATE BUELL SERVICE CORPORATION
5013 N.E. 42nd STREET
PORTLAND, OREGON 97218**

**HARRY C. MILLER CO., INC.
257 PARK AVENUE SOUTH
NEW YORK, NEW YORK 10010**

**SHERMAN LOYD SALES COMPANY
4737 GREENVILLE AVENUE
DALLAS, TEXAS 75206**